

Page 1 of 2

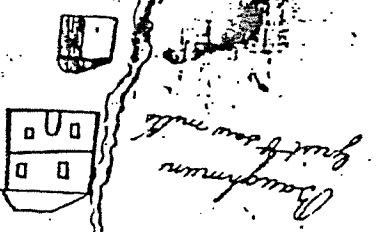
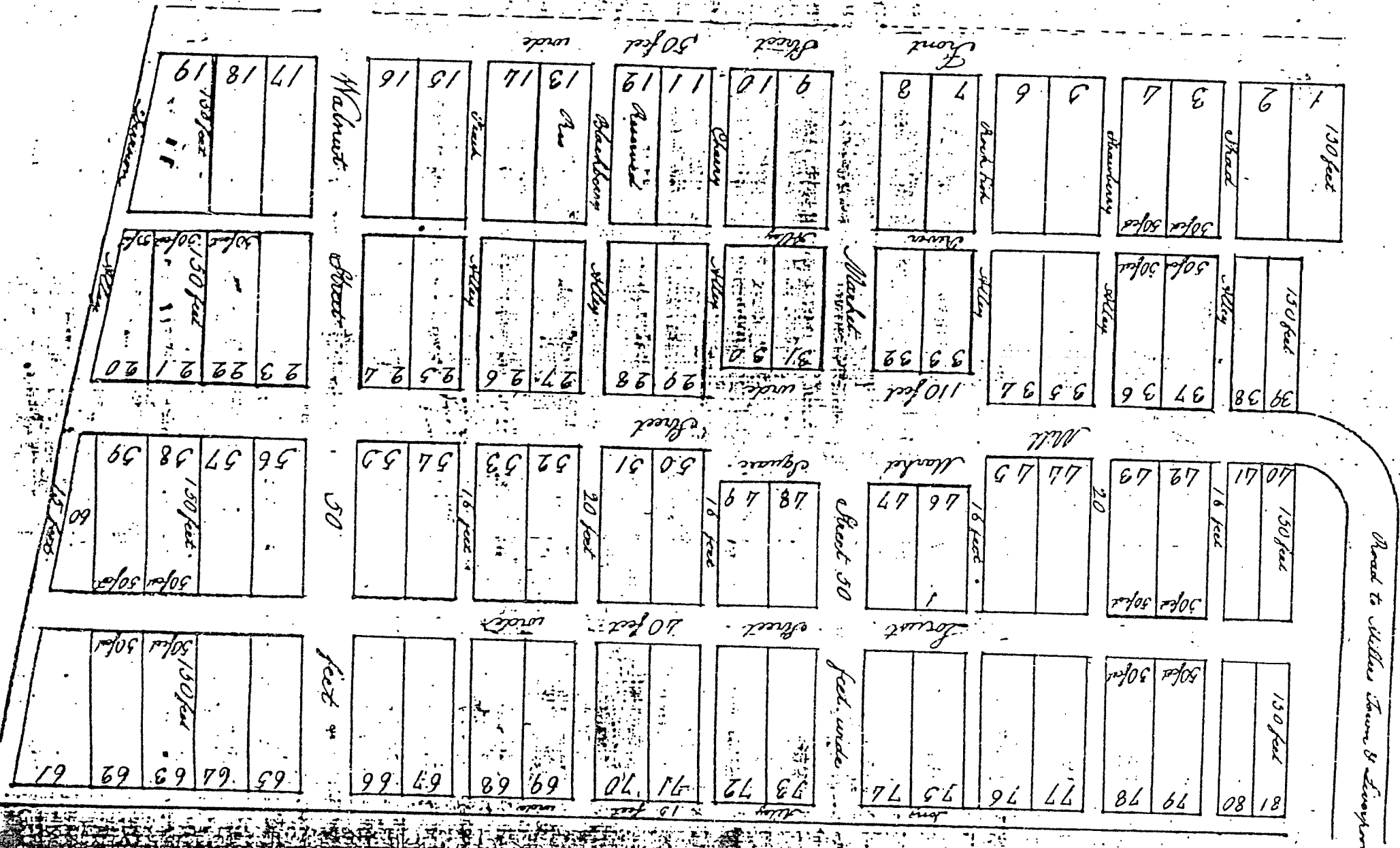

Mill

Road to Village Square & Church

every Sunday at 177

Before me the Subscriber a Justice of the Peace in & for said County personally Examined the foregoing agreement between the said parties to the said agreement & having read the same and the instrument to which the same are annexed and being satisfied that the same are the acts and deeds of the parties to the same I have hereunto set my hand and seal at the City of New York the 18th day of March AD 1825
(Compared)

For the Subscribers
Jacob Baughman
deputy
of said City
of the town
called New
Buffalo
situate in
the County
of
Schenectady

A NEW TOWN in the town of Buffalo, called New Buffalo, consisting of 17 lots at Baughman's Ferry in Buffalo County, the land being situated in a healthy part of the country and in a neighborhood that is being improved for many years. The town is situated in a healthy part of the country and in a neighborhood that is being improved for many years. The town is situated in a healthy part of the country and in a neighborhood that is being improved for many years.

The land on the town is reserved by the proprietor for the purpose of a place of woodchop and a shanty for the use of the town. The land on the town is reserved by the proprietor for the purpose of a place of woodchop and a shanty for the use of the town. The land on the town is reserved by the proprietor for the purpose of a place of woodchop and a shanty for the use of the town.

Jacob Baughman

ROAD MILEAGE AND TYPE REPORT
 FOR

CITIES, BOROUGHS, FIRST AND SECOND CLASS TOWNSHIPS

DATE May 21, 1968 Sheet 1 of 1 Pages
 COUNTY Ferry
 MUNICIPALITY New Buffalo

| STREET NAME OR ROUTE NUMBER | BEGINNING | ENDING | IDENTIFICATION AND LOCATION OF STREETS OR ROADS | CARTWAY RIGHT OF WAY | RIDTDS | MILES OF THE VARIOUS TYPES | | | | | MILES | REMARKS |
|-----------------------------|-----------------|------------------|---|-------------------------------|--------|----------------------------|----------|----------------------|-----------------------|-----------------|-------|---------|
| | | | | | | ASPHALT SHEET | CONCRETE | BRICK OR BLOCK | BITUMINOUS SURFACE | HARD SURFACE | | |
| Front | N. Boro. Line | S. of Spad Alley | | 12' | 33' | | | | | | 0.21 | |
| M111 | N. Boro. Line | Market | | 18' | 50' | | 0.13 | | | | 0.13 | |
| M111 | Millerstown Rd. | S. Boro. Line | | 18' | 50' | | | 0.07 | | | 0.07 | |
| Locust | Walnut | Millerstown Rd. | | 16' | 70' | | | | | | 0.19 | |
| High | Walnut | S. Boro. Line | | 12' | 15' | | | | | | 0.22 | |
| Strawberry | High | Front | | 14' | 20' | | | | | | 0.12 | |
| Market | High | M111 | | 16' | 50' | | | | | | 0.06 | |
| Blackberry | Front | Pt. W. of Market | | 12' | 20' | | | | | | 0.10 | |
| Walnut | High | Front | | 16' | 50' | | | | | | 0.12 | |

MUNICIPALITY MILEAGE ONLY
 STATE HIGHWAY

Mileage as of January 1, 19
 Previous not change since 1-1-19
 Subject
 Net change - this report
 Total mileage as of this date
 Total mileage within municipality as of this report 1.19 miles

NOTE - Show mileage to nearest 100th of a mile. - Show only one-half mile for boundary line streets or roads.
 * Include sidewalks paved macadam, bituminous concrete or stone base.
 ** Include stone, slag, gravel, dirt, hard - shale or red dog.
 Show cartway and right of way width. Note: - Roads or streets having less than a legal 33 foot right of way.
 Are not acceptable for certified mileage, unless covered by curbs, sidewalks, or declines whose footage about street.
 In no case shall right of way be less than 30 feet.

This statement shall not include streets maintained by the Department of Highways, or Alleys, Ways, Courts, and those not physically opened on the ground.